

FLOWZZ 100 and 115 zip screens - fitting instructions

Overview of the parts of the Flowzz

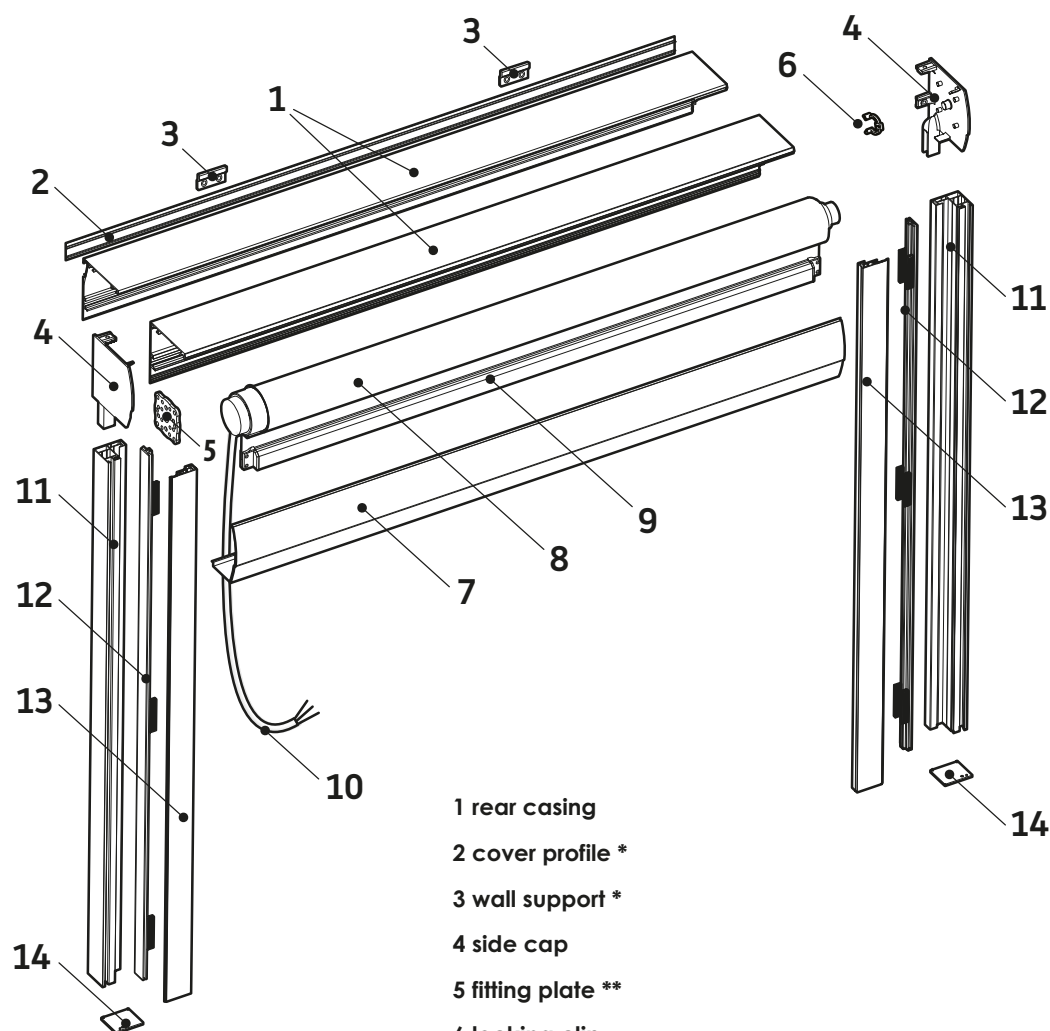

- 1 rear casing
- 2 cover profile *
- 3 wall support *
- 4 side cap
- 5 fitting plate **
- 6 locking clip
- 7 front casing
- 8 tube with motor and cloth
- 9 bottom strip
- 10 power cable
- 11 rear part of guide
- 12 inlay
- 13 front part of guide
- 14 guide cap

* Only used for Flowzz 130 and Flowzz 85

** not used with Somfy motors

1 Packet contents

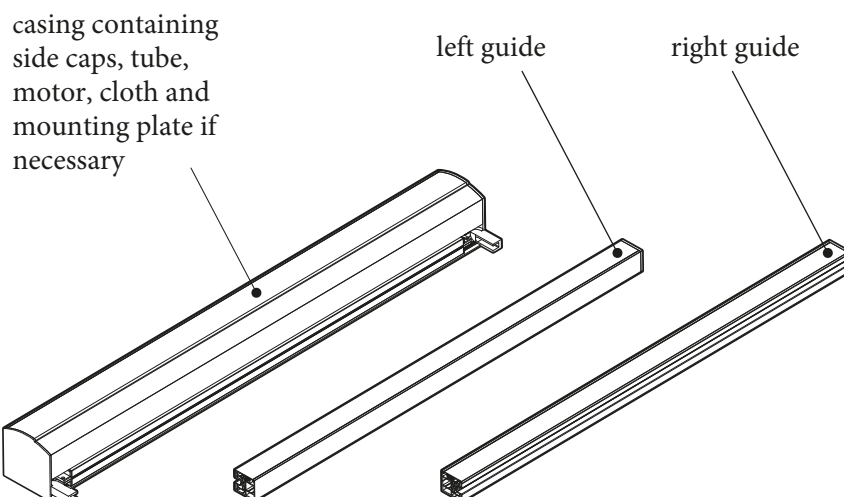

2 Remove the screws from the guides and dismantle them

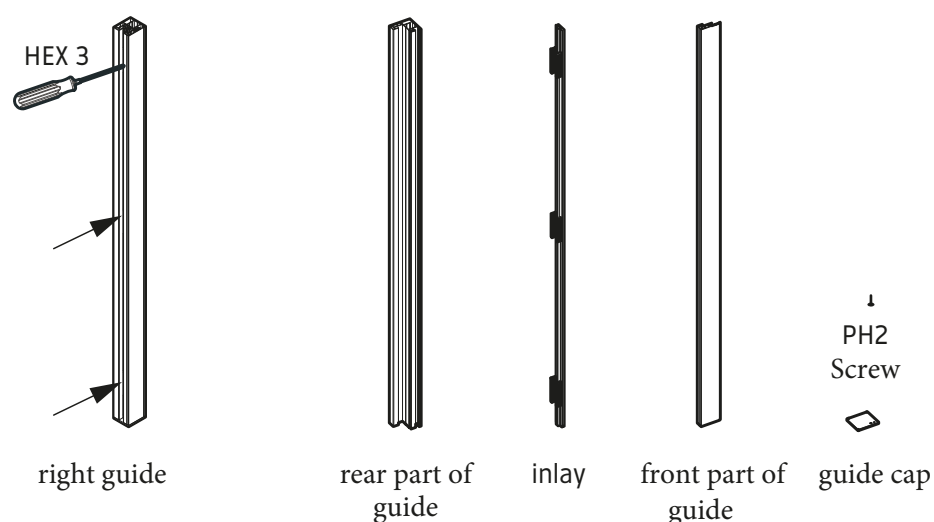

3 Drill the mounting holes in the rear part of the guides

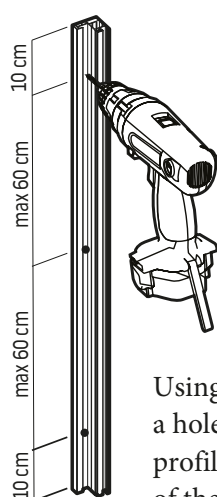

Using a 10mm Ø drill, drill a hole through the first profile wall in the rear part of the guide.

Screws per guide:

- 10 cm from the bottom and 10 cm from the top
- Intermediate distance between the screws is 60cm max.

Repeat on the second guide

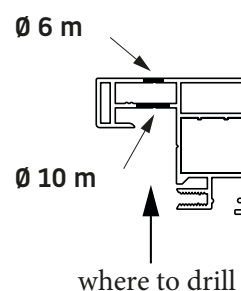

4 Mount Flowzz 115 on the pergola

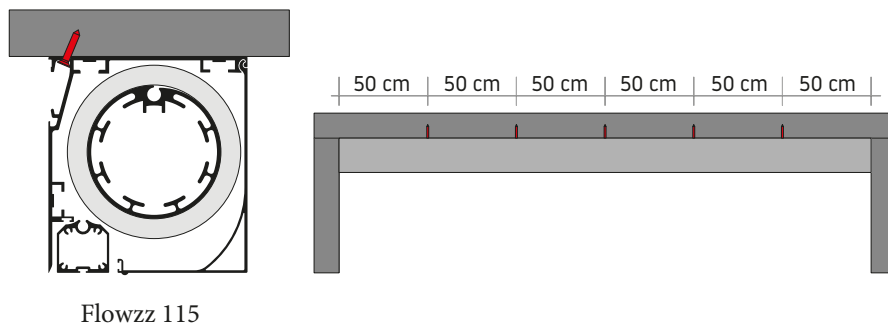

5 Mount the rear part of the guide on the wall (Flowzz 100)

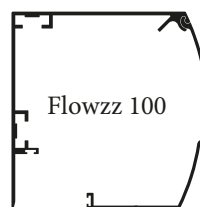
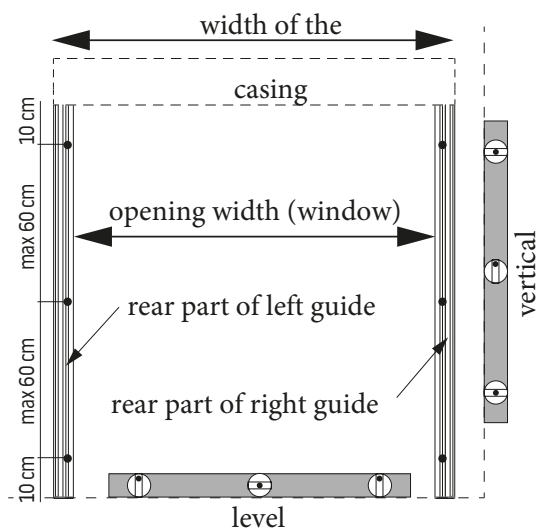

Level the guides and adjust the spacing to the width of the casing. Level the guides and adjust the spacing to the width of the casing.

Fit wall plugs (suitable to the type of wall) in mounting holes (see point 3).

6 Mount the casing

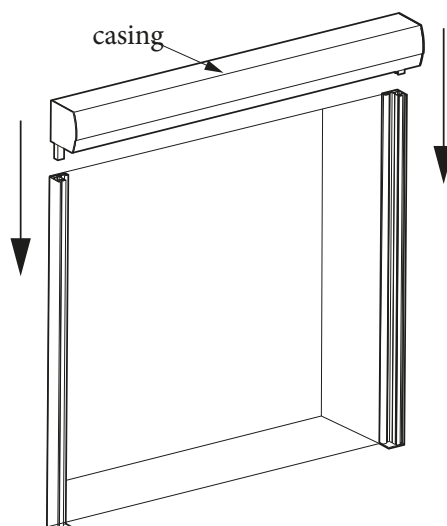

7 Dismantle the front cover

a - remove the screws

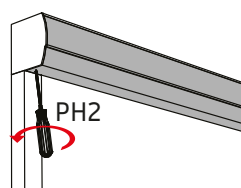

b - pull until couplings are free

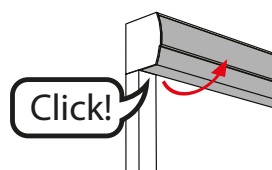

c - rotate upwards

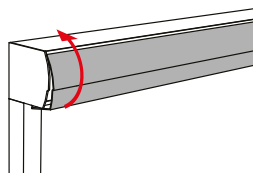

d - unhook

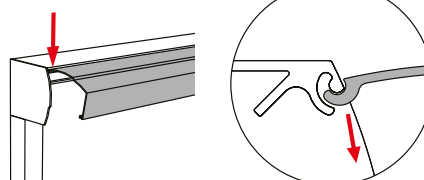

8 Put the power supply cable in the guide if necessary (only for STG guide)

STG guide

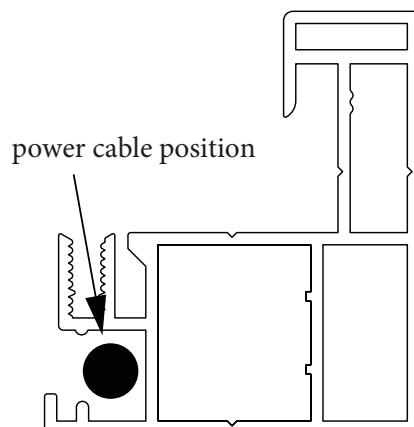

9 Set end positions

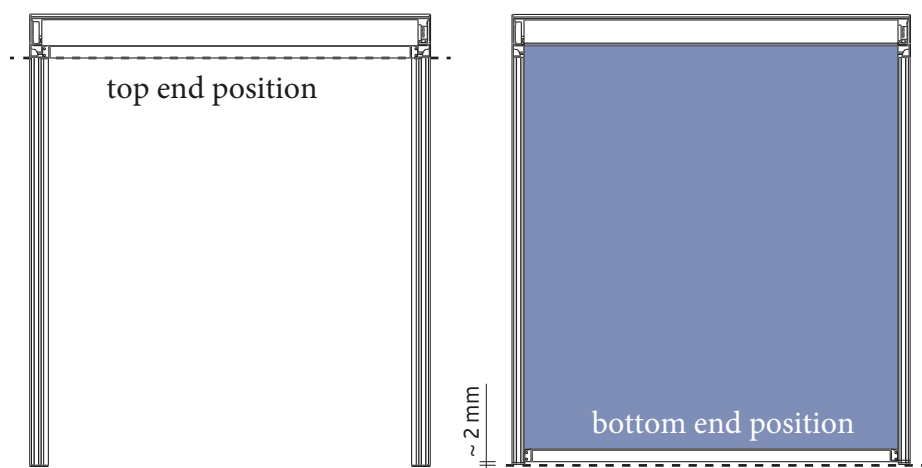

10 Install the inlay in the left and right guides

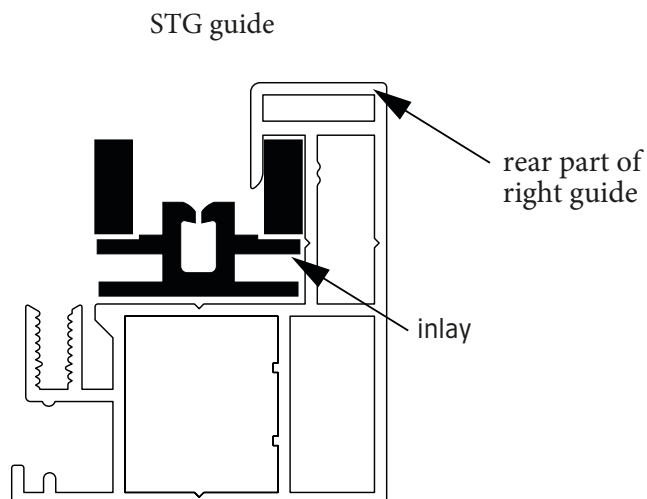

11 Front part of left and right guides

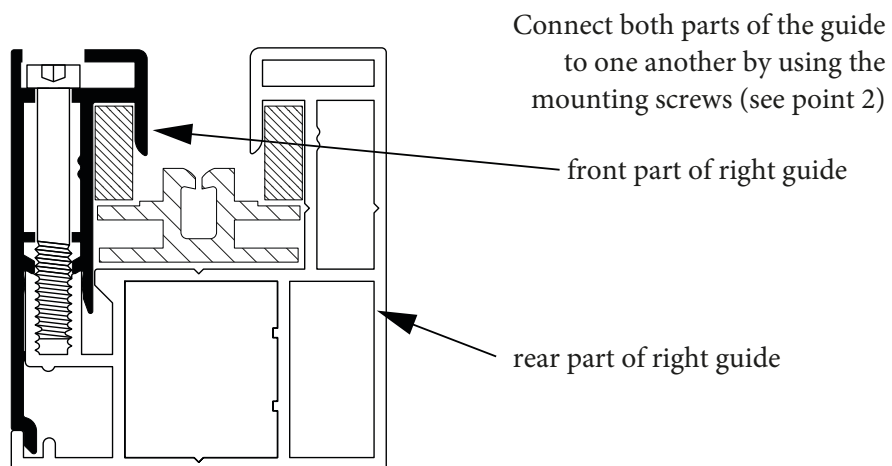

12 Mount the front cover of the casing

a - hook into place

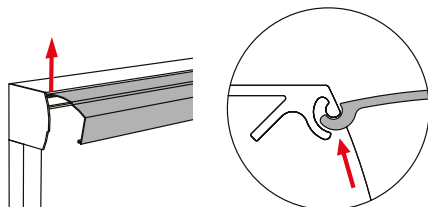

b - rotate downwards

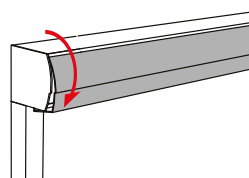

c - push closed (until it clicks into position)

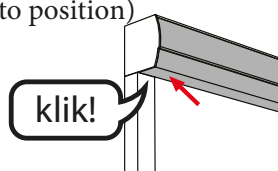

d - tighten the screws

